

MODEL C1 ANCHOR CATCHER

PRODUCT 20-033

The **TechWest C1 Anchor Catcher** is a mechanical set, retrievable double-grip tubing anchor designed to anchor the tubing string in tension or compression. The C1 Anchor catcher is a simple and rugged tool, with decades of proven results.

The opposing slips are incorporated so that if the tubing parts or backs off it prevents the tubing from free falling to the bottom of the well.

This C1 Anchor Catcher incorporates an emergency shear release system which is easily adjustable in the field. Unless otherwise specified, anchors are furnished with a total of 22,000 daN (50,000 lbs.) secondary release shears.

OPERATION

Run to desired depth and rotate the tubing to the left to set the Anchor Catcher. The number of turns required will depend on the casing weight. When the slips have set the tubing will torque up.

To retrieve the Anchor Catcher, release the tension and rotate to the right while working the tubing up and down slightly.

Should the Anchor Catcher fail to release with normal procedures, the anchor may be shear released with straight pull.

MODEL CR ANCHOR CATCHER

PRODUCT 20-233

The CR Anchor is identical to the TechWest C1 Anchor except that it is RH Set/LH Release (instead of LH Set/RH Release).

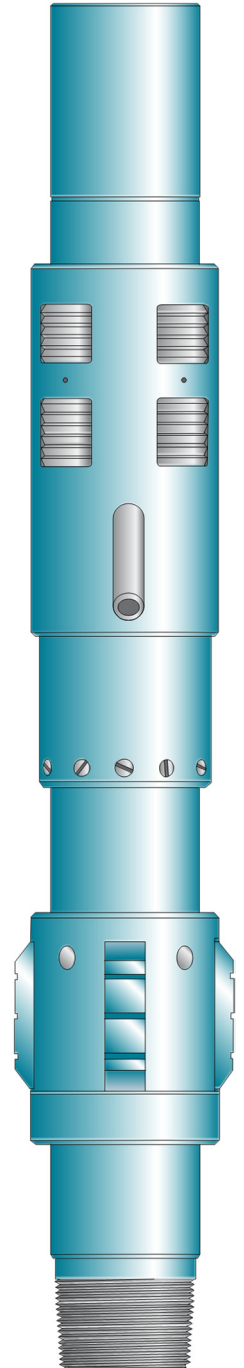

SPECIFICATIONS

20-233 and 20-033 SPECIFICATION GUIDE													
Casing					Anchor								
Size	Weight		ID		CR Product Number	C1 Product Number	Min		Max		ID		EUE Thread
in/m m	lb/ft	kg/m	in	mm			in	mm	in	mm	in	mm	in
4 1/2 114.3	15.1	22.5	3.826	97.2	20-233-0450	20-033-0453	3.500	88.9	4.070	103.4	1.500	38.1	2 3/8
	13.5	20.1	3.920	99.6	20-233-0460	20-033-0463	3.812	96.8	4.320	109.7	1.930	49.0	2 3/8
	9.5	14.1	4.090	103.9									
5 127.0	18	26.8	4.276	108.6	20-233-0500	20-033-0503	4.124	404.7	4.759	120.9	1.930	49.0	2 3/8
	11.5	17.1	4.560	115.8									
5 1/2 139.7	26.8	39.9	4.500	114.3	20-233-0520	20-033-0523	4.250	108.0	4.884	124.1	2.347	59.6	2 7/8
	26	38.7	4.548	115.5	20-233-0530	20-033-0533	4.420	112.3	5.134	130.4			
	26	38.7	4.548	115.5	20-233-0540	20-033-0543	4.504	114.4	5.134	130.4	1.995	50.7	2 3/8
	20	29.8	4.778	121.4	20-233-0550	20-033-0553					2.347	59.6	2 7/8
	17	25.3	4.892	124.3	20-233-0560	20-033-0563	4.754	120.8	5.384	136.8	2.347	59.6	2 7/8
	13	19.3	5.044	128.1									
6 5/8 168.3	28	41.7	5.791	147.1	20-233-0650	20-033-0653	5.686	144.4	6.435	163.5	3.000	88.9	2 7/8
	20	29.8	6.049	153.6	20-233-0660	20-033-0663							3 1/2
7 177.8	38	56.6	5.920	150.4	20-233-0700	20-033-0702 20-033-0703*	5.874	149.2	6.724	170.8	3.000	88.9	2 7/8
	23	34.2	6.366	161.7	20-233-0710	20-033-0713	5.874	149.2	6.724	170.8	3.000	88.9	3 1/2
	20	29.8	6.456	164.0	20-233-0730	20-033-0733	6.250	158.8	7.120	180.8	3.000	88.9	2 7/8
	17	25.3	6.538	166.1	20-233-0740	20-033-0743							3 1/2
7 5/8 193.7	39	58	6.625	168.3	20-233-0750	20-033-0753	6.374	161.9	7.244	184.0	3.000	88.9	2 7/8
	24	35.7	7.025	178.3									
8 5/8 219.1	49	72.9	7.511	190.8	20-233-0850	20-033-0853	7.250	184.2	8.188	208.0	4.000	101.6	3 1/2
	24	35.7	8.097	205.7									
9 5/8 244.5	47	69.9	8.681	220.5	20-233-0950	20-033-0953	8.120	206.2	8.938	227.0	4.000	101.6	4 1/2
	32.3	48.1	9.001	228.6									

* 20-033-0703 comes with couplings and inserts